



# INSTALLATION INSTRUCTIONS

Publication No. 1532 / UPDATE 03.09 Id. No. 050010



### Fig. 1 Accessories / Zubehör

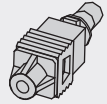

**LWL ST DSI (10 pcs.)**  
Connector  
Part No. 910 641

**LWL DSI 18M**  
Plastic optical fibre  
No. 910 642

#### Technical Data



optical fibre bundle: 18 m		
<b>LWL DSI</b>		
loss at 660 nm		< 200 dB / km
Installation	9	-25°C ... +85°C
Operating	9	-35°C ... +85°C
Storage	9	-35°C ... +85°C

### Fig. 2 Connection / Anschluss

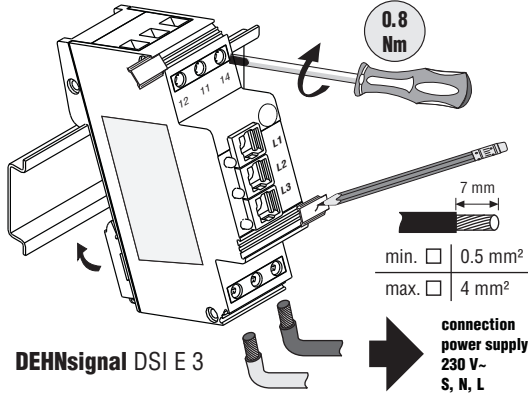

### Fig. 3 Technical Data / Technische Daten

DEHNSignal E 3		DSI E 3
U <sub>N</sub>		230 V~
max. I		16 A g/LgG (C16 A)
P		< 550 mW
9°C		-40°C ... +80°C
IP Code		IP 20
<b>floating changeover contact</b>		
U <sub>N</sub> / I <sub>N</sub>		AC: 250V / 0.5A DC: 250V / 0.1A; 125V / 0.2A 75V / 0.5A
min. □		0.5 mm <sup>2</sup>
max. □		4 mm <sup>2</sup>

### Fig. 4 Function / Funktion

DEHNSignal DSI E 3			DBM 1 255 S / DGPM 1 255 S	
LED red	LED green	signal	Function	Check
L1 ● L2 ● L3 ●			<b>ok</b> L1 + L2 + L3 (N)	- - -
L1 and/or L2 and/or L3	●		<b>check</b> power supply 230/400 V- (L1 and/or L2 and/or L3)	 no <b>ok</b> yes 
L1 ● L2 ● L3 ●	●		<b>check</b> ⇒ power-supply 230 V~ (L/N) of DSI E 3 ⇒ backup fuse F of DSI E 3 ⇒ connection of DSI E 3 see Fig. 6b	 no <b>ok</b> yes 

### Fig. 5 Fibre Optic Cable assembling / Montage des Lichtwellenleiters

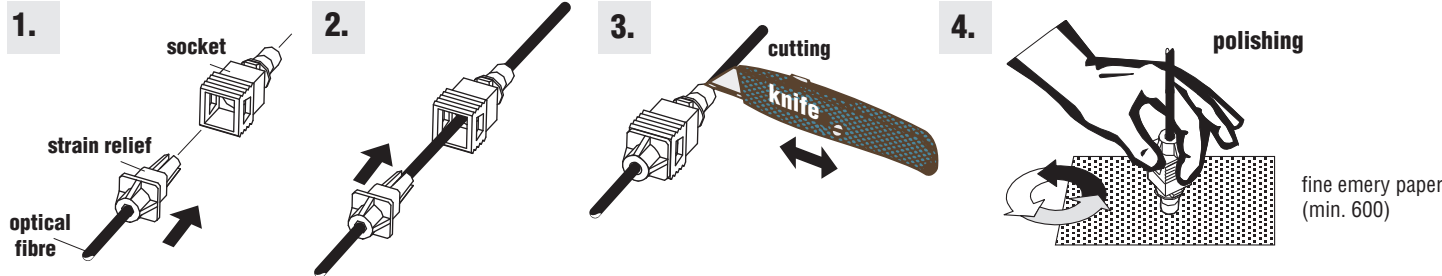

### Fig. 6a TN-C System: Application and Connection / Anwendung und Anschluss

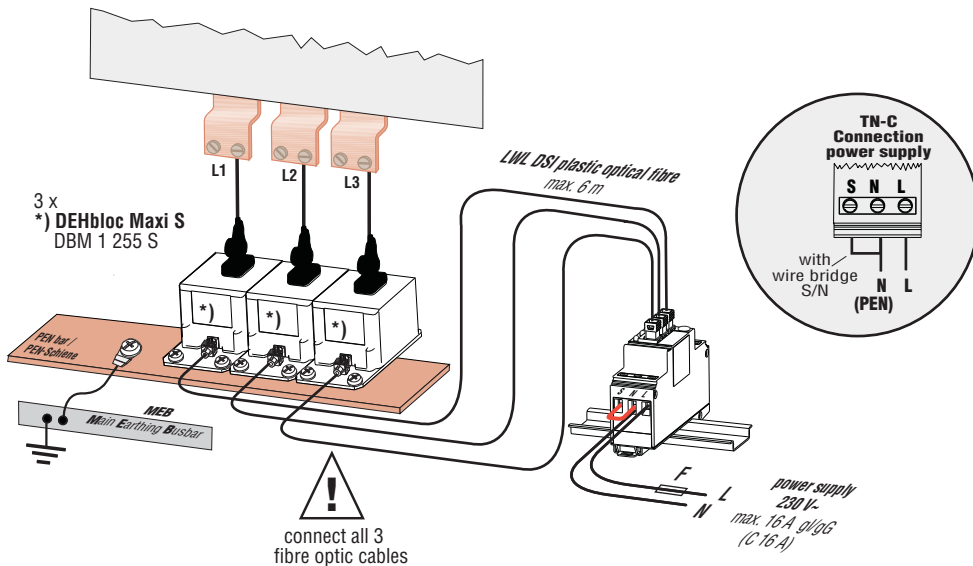

### Fig. 6b TN (-C)-S System: Application and Connection / Anwendung und Anschluss

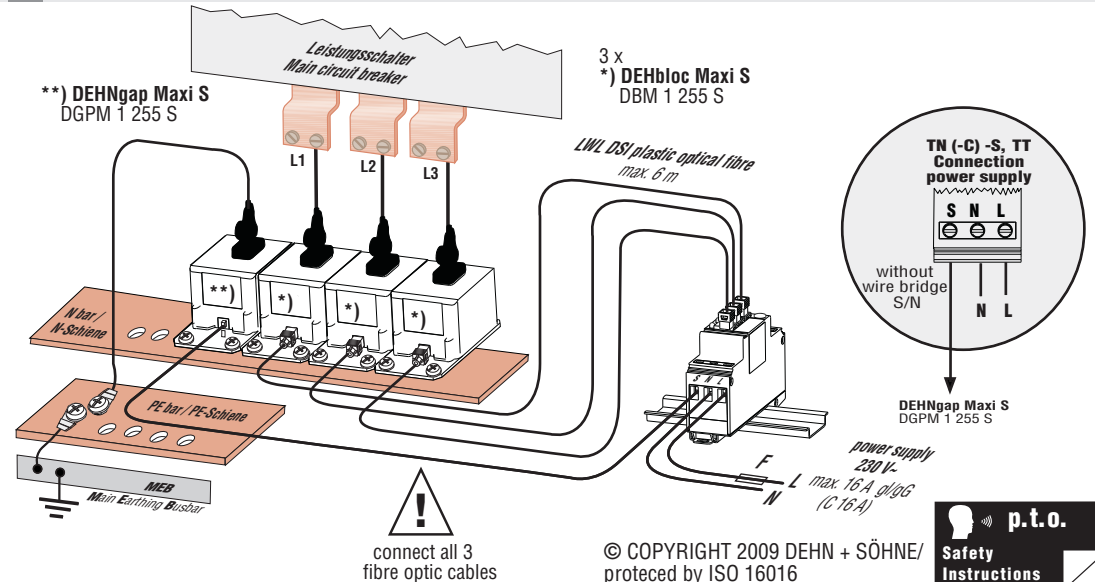

© COPYRIGHT 2009 DEHN + SÖHNE/protected by ISO 16016



